

RS683 INSTRUCTIONS

TO BE INSTALLED BY A CERTIFIED MECHANIC ONLY | FOR RACE USE ONLY

BRAKE SIDE EXPLODED VIEW

FOR: YAMAHA R1 2015



INDEX



Lubricate



Red Thread Lock



DO NOT Overtighten

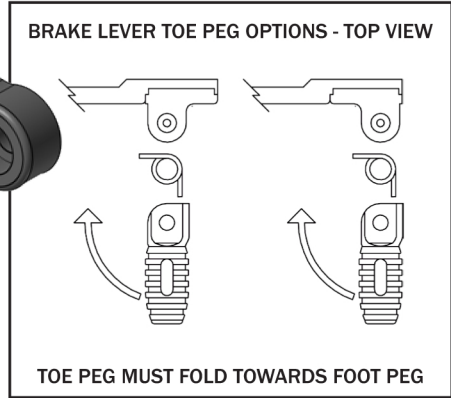
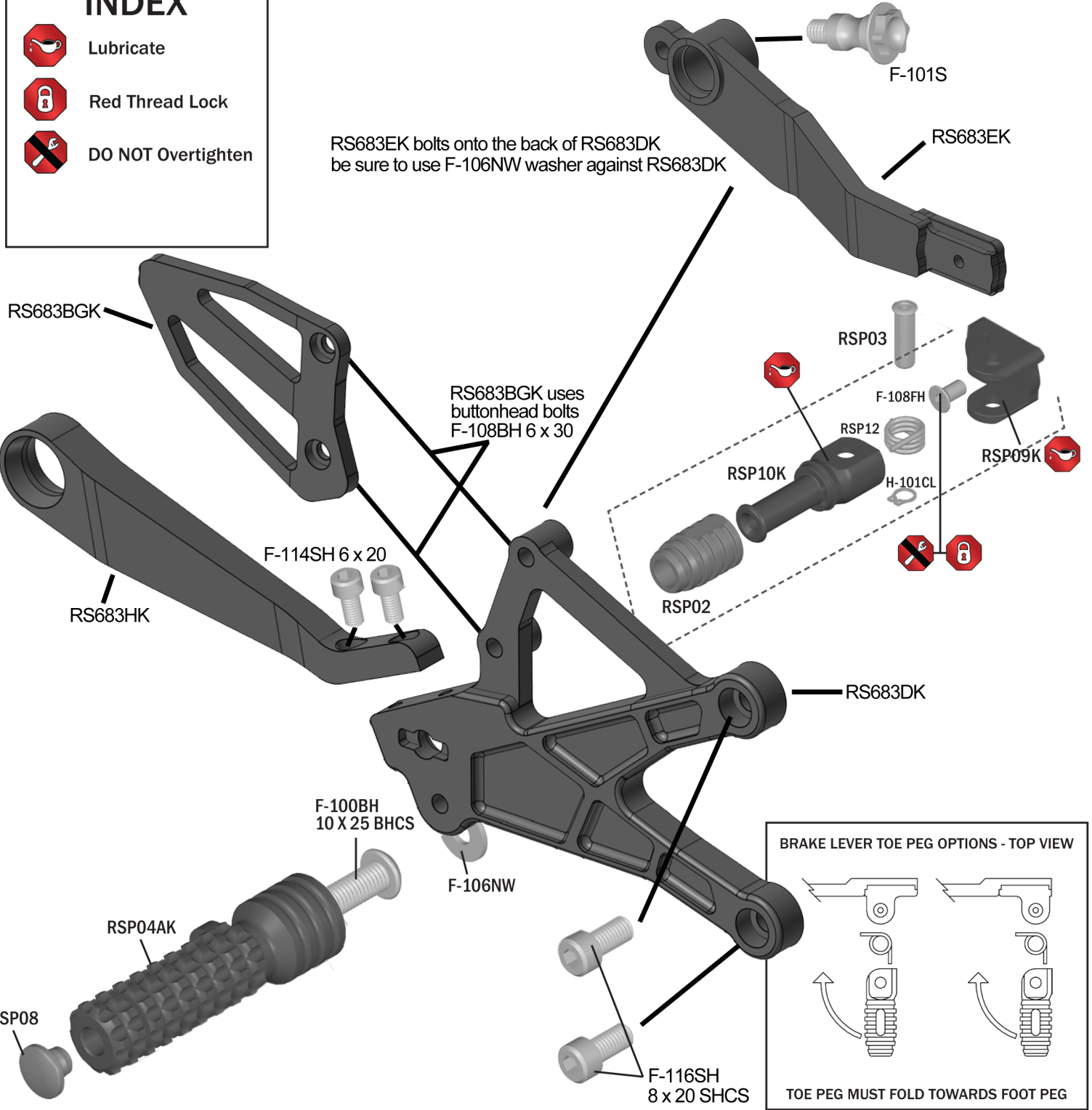

BRAKE LIGHT INFO:
 These rearsets do not use: OEM rear brake light switch, spring & lever return spring. In race form these rear sets no longer activate rear brake light from rear brake lever. Street use requires rear brake light to be activated by rear & front brake levers. To achieve rear brake light activation from rear brake lever use Vortex in-line pressure switch RS100.



RS683 INSTRUCTIONS

TO BE INSTALLED BY A CERTIFIED MECHANIC ONLY | FOR RACE USE ONLY

SHIFT SIDE EXPLODED VIEW

FOR: YAMAHA R1 2015



INDEX

- Lubricate
- Red Thread Lock
- DO NOT Overtighten

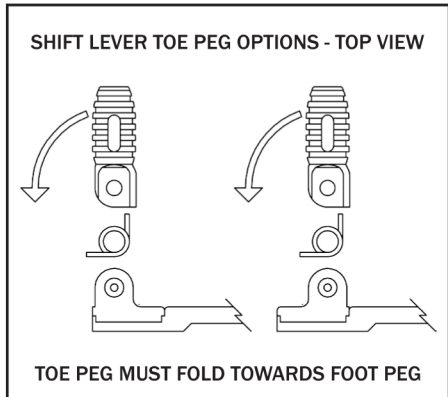
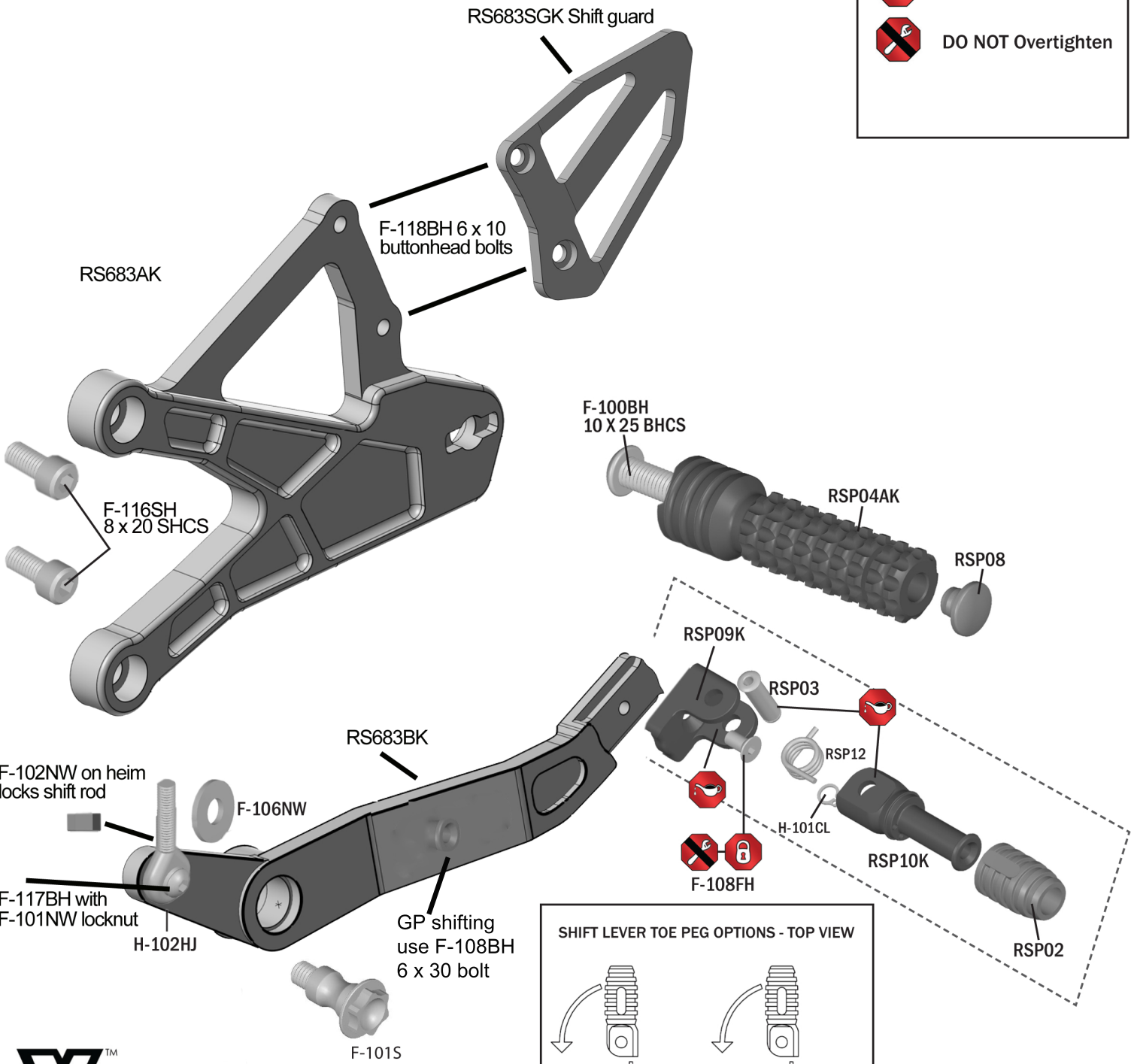

1.800.440.3559
www.VORTEXRACING.com

