

RS661 INSTRUCTIONS

TO BE INSTALLED BY A CERTIFIED MECHANIC ONLY | FOR RACE USE ONLY

BRAKE SIDE EXPLODED VIEW

FOR: YAMAHA R1 07-08 ADJUSTABLE



INDEX

- Lubricate
- Red Thread Lock
- DO NOT Overtighten
- Use Factory Piece

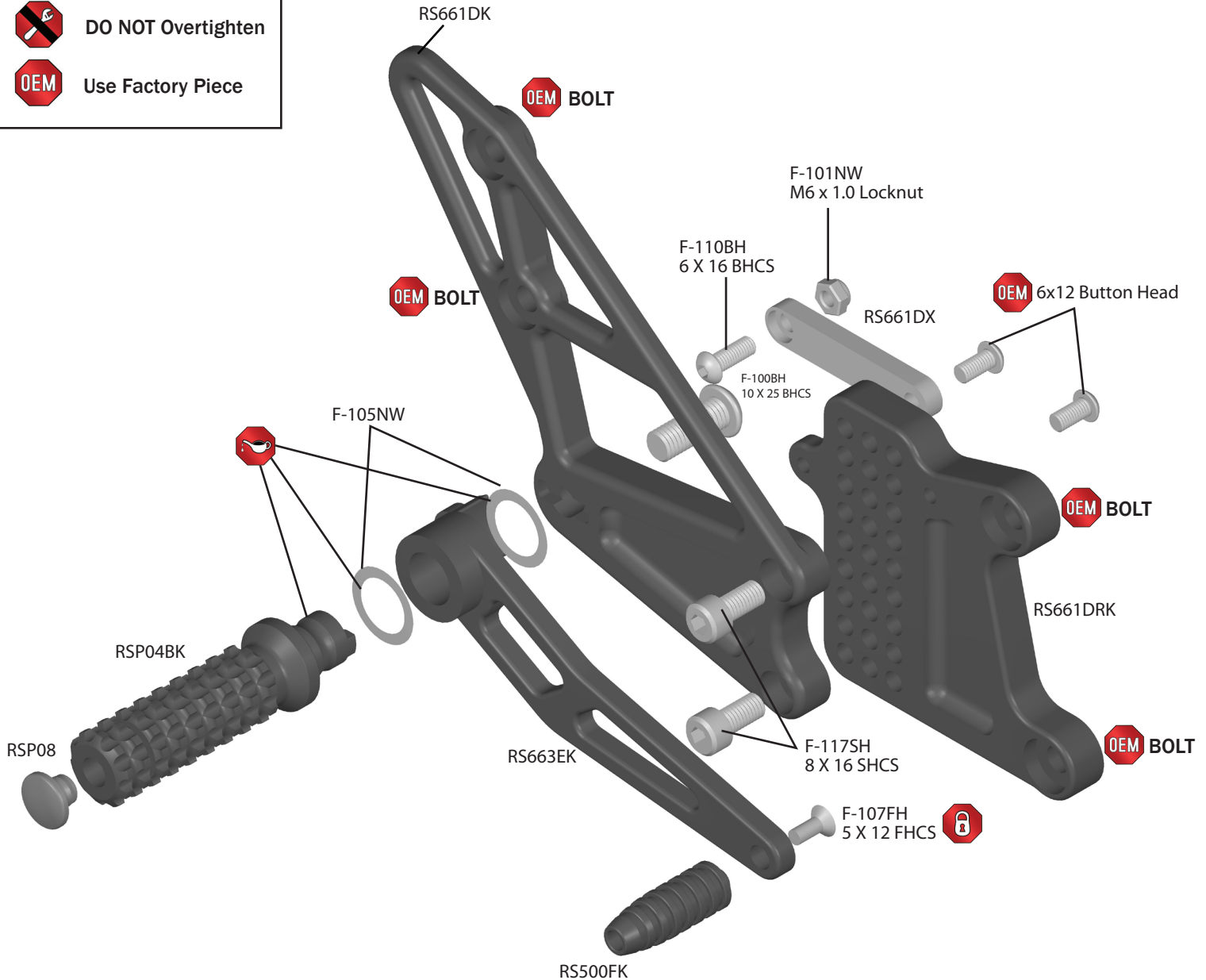

1.800.440.3559
www.VORTEXRACING.com



RS661 INSTRUCTIONS

TO BE INSTALLED BY A CERTIFIED MECHANIC ONLY | FOR RACE USE ONLY

SHIFT SIDE EXPLODED VIEW

FOR: YAMAHA R1 07-08 ADJUSTABLE



INDEX



Lubricate



Red Thread Lock



DO NOT Overtighten



Use Factory Piece

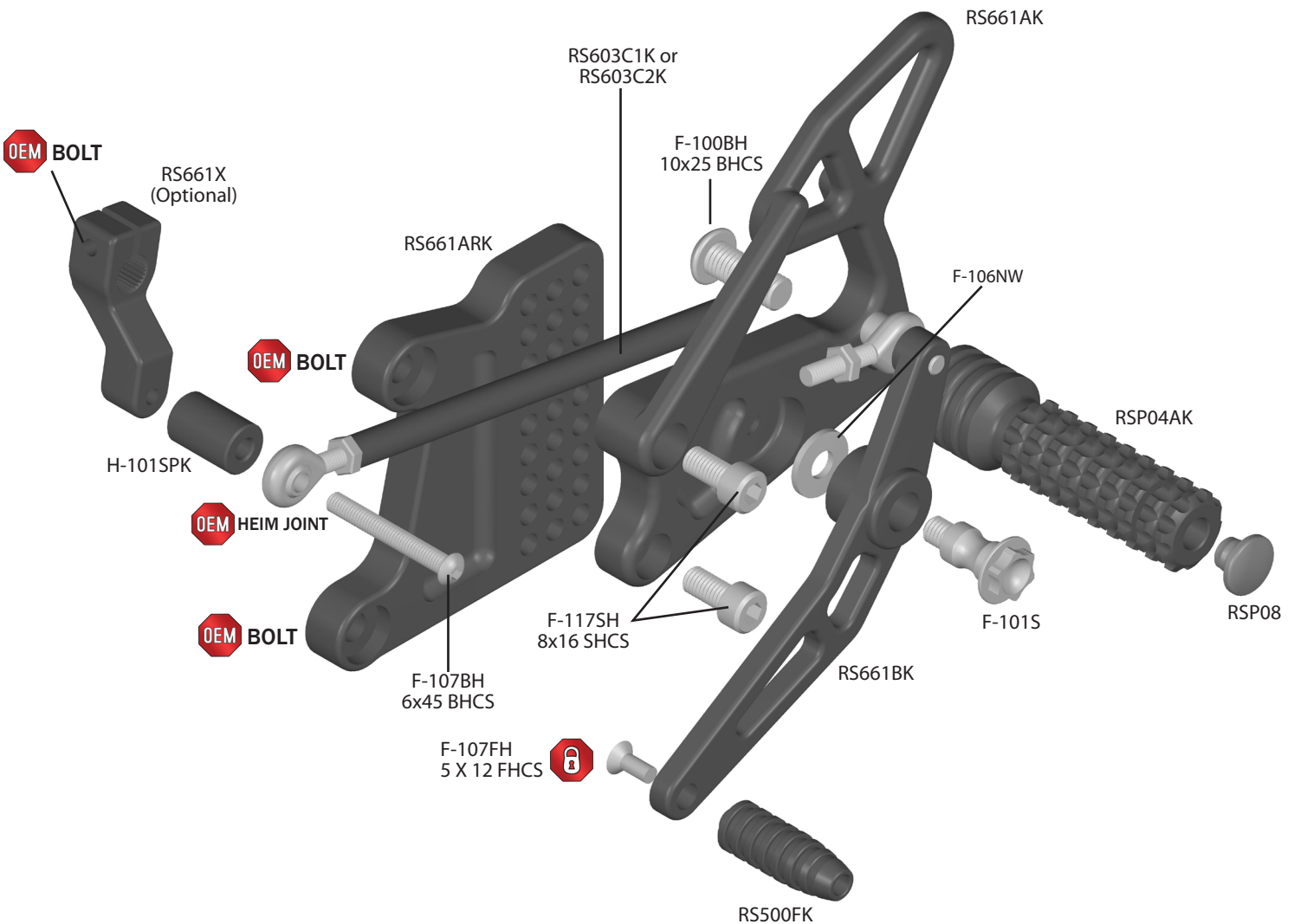

1.800.440.3559
www.VORTEXRACING.com

