

# RS198 INSTRUCTIONS

TO BE INSTALLED BY A CERTIFIED MECHANIC ONLY | FOR RACE USE ONLY

## BRAKE SIDE EXPLODED VIEW

FOR: DUCATI 848 / 1098 ADJUSTABLE



### INDEX



Lubricate



Red Thread Lock



DO NOT Overtighten



Use Factory Piece

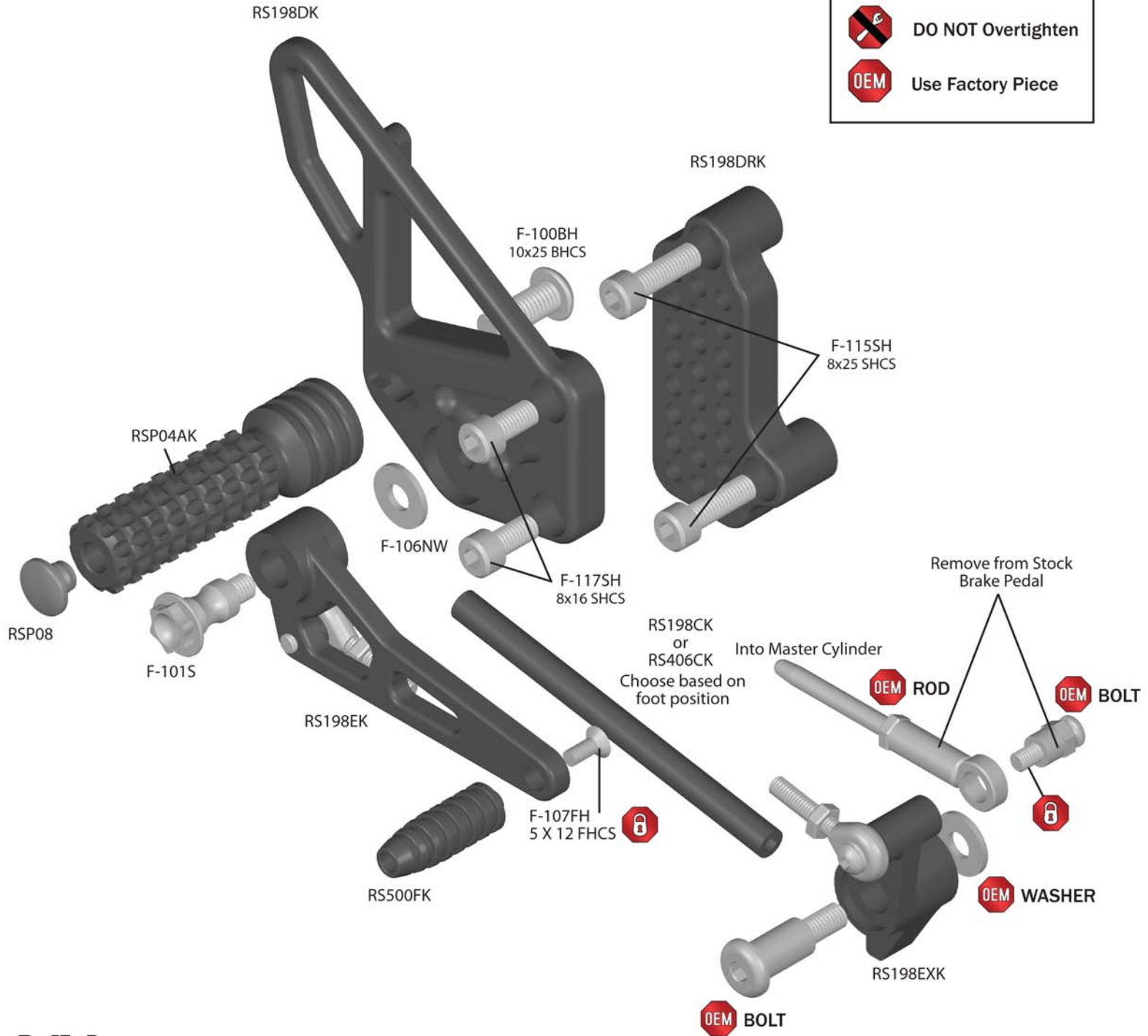

1.800.440.3559

www.VORTEXRACING.com



# RS198 INSTRUCTIONS

TO BE INSTALLED BY A CERTIFIED MECHANIC ONLY | FOR RACE USE ONLY

## SHIFT SIDE EXPLODED VIEW

FOR: DUCATI 848 / 1098 ADJUSTABLE



### INDEX

-  Lubricate
-  Red Thread Lock
-  DO NOT Overtighten
-  Use Factory Piece

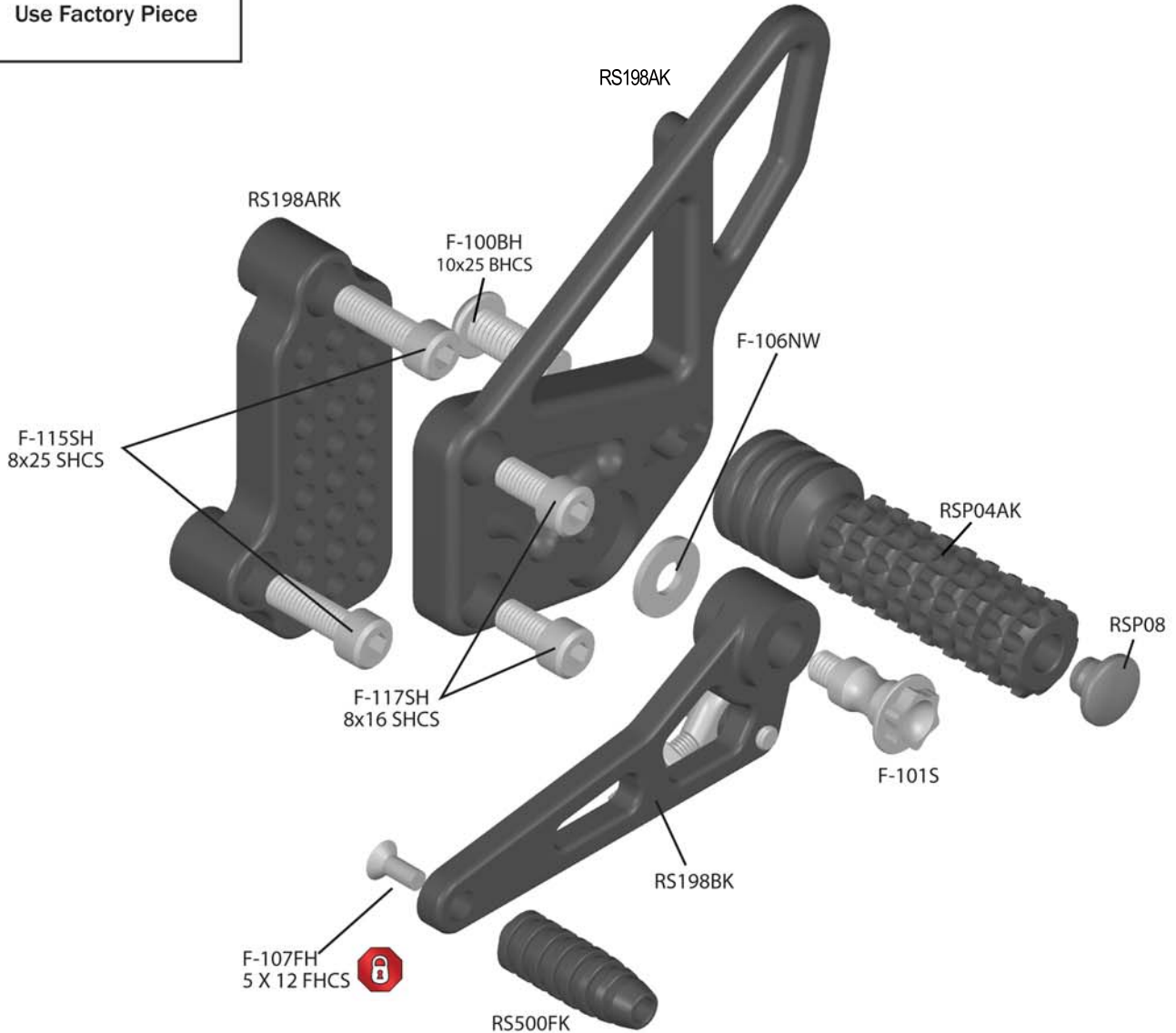

1.800.440.3559

www.VORTEXRACING.com

